

CH1 / CH1-1L

VERTICAL STRAPPING MACHINE WITH SHEET-INSERTER

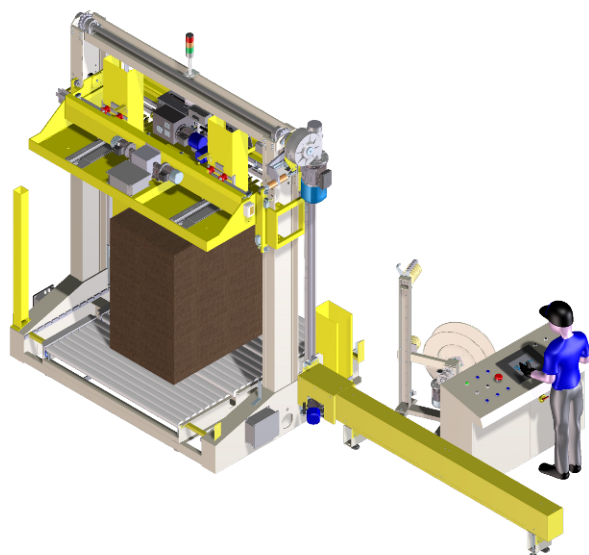

Standard CH-1 / CH1-1L TECHNICAL SPECIFICATIONS

Operation voltage: 400V 3 ph + PE + Neutral upon request

Max. total installed power: 8 KW, possible accessories excluded

Working pressure of compressed air 6 Bar.

The compressed air consumption is about 35 NI for every single strapping cycle.

The bidirectional motorized roller conveyor is adjusted by inverter from 12 to 18 mt/min.

Maximum total weight of the machine and accessories: 3500 Kg. The environmental conditions foresee the operation of the machine with a temperature from 10 to 50 degrees Centigrade and a maximum humidity of 90%.

Strap

TA10 model strapping head.

Polypropylene (PP) or polyester (PET) strap of 12 or 9 mm, with a thickness from 0,60 to 0,90 mm according to the material.

The bobbin has an internal diameter of 395 or 405 mm.

Protection sheet

The 295x195 1 or 2 flutes cardboard sheet must have a thickness between 5 and 7 mm with the orientation of the rods as in the image to the right.

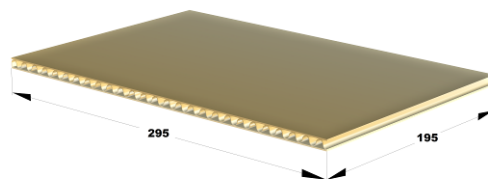

Machine standard sizes

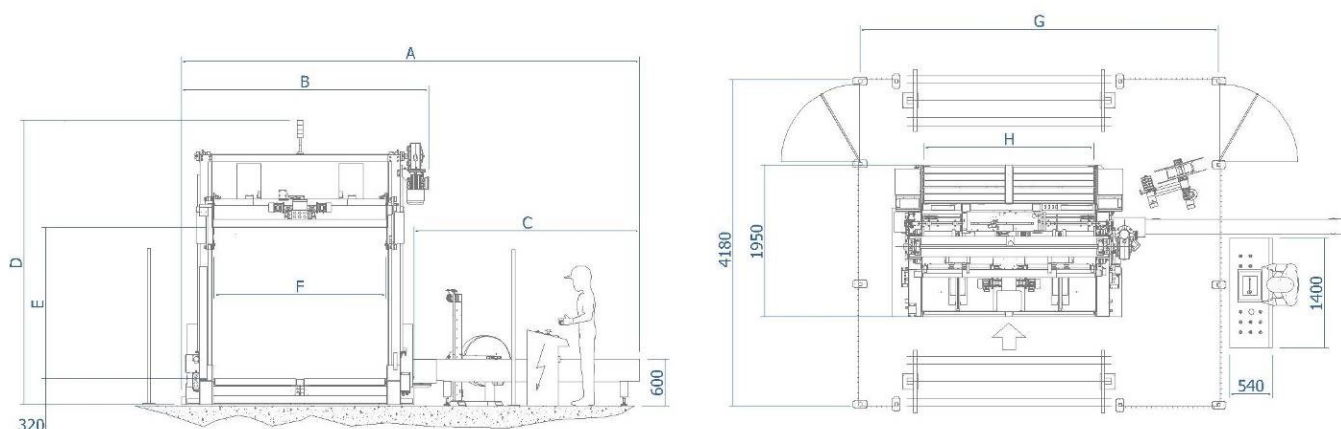

The dimensional drawing refers to the version with lance, decoiler and electric panel on the right, but they can be positioned in both sides. The SIZE table indicates the standard widths of the machine, the MODEL table indicates the heights.

SIZE	A	B	C	F	G	H
2200	5845	3152	3020	2150	4600	2175
2500	6145	3452	3320	2450	4900	2475
2800	6445	3752	3620	2750	5200	2775

MODEL	D	E
CH 19	3650	1900
CH 23	4050	2300
CH 26	4350	2600

Sizes of the workable product

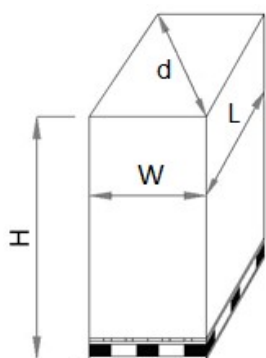

The depth (L) of the package is limited to 2000 mm for a better management of transport line, also if theoretically has no limits. The strapping product has the following maximum measures, according to the machine, while all the minimum dimensions are 500 mm.

SIZE	F	W max
2200	2150	2050
2500	2450	2350
2800	2750	2650

MODEL	E	H max
CH 19	1900	1850
CH 23	2300	2250
CH 26	2600	2550