

PC 2

COMPACT JOGGER WITH TURNING-PACKAGE DEVICE

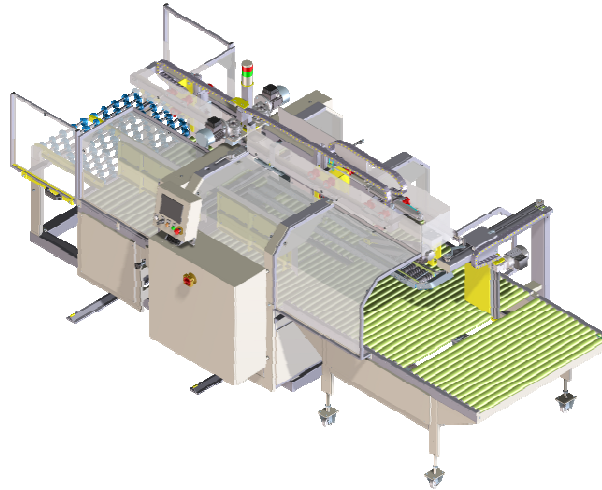

PC 2 TECHNICAL SPECIFICATIONS

Operation voltage: 400V 3 ph + PE, with max. total installed power of 3 KW.

Working pressure of compressed air 6 Bar.

The compressed air consumption is about 26 NI for every single strapping cycle.

Motorized roller conveyor with different sections has 57 mt/min entry speed.

Maximum total weight of the machine and accessories: 2800 Kg. The environmental conditions foresee the operation of the machine with a temperature from 10 to 50 degrees Centigrade and a maximum humidity of 90%.

Strap

TA05 model strapping head. Polypropylene (PP) Strap of 5 mm, with a thickness of 0,40 mm up to the 1450 model, with a thickness of 0,45 from the 1650 width model on. Length of the strap wrapped on the bobbin up to 6500 mt, according to the thickness. The bobbin has an internal diameter of 200 mm.

Performances

The number of single strapping per minute ranges from 13 packages for larger models to 17 packages of smaller size.

Sizes of the workable product

The maximum depth of the package is 1500 mm, which in the MAXI version becomes 1800 mm, while the height goes from 50 to 300 mm. In the case of two strapping with a distance of 100 mm from the front edge, the length of the package is reduced to 1000 mm. The maximum width measurement of the strapping product is 50 mm less than the width of the machine passage, starting from 250 mm

Machine standard sizes

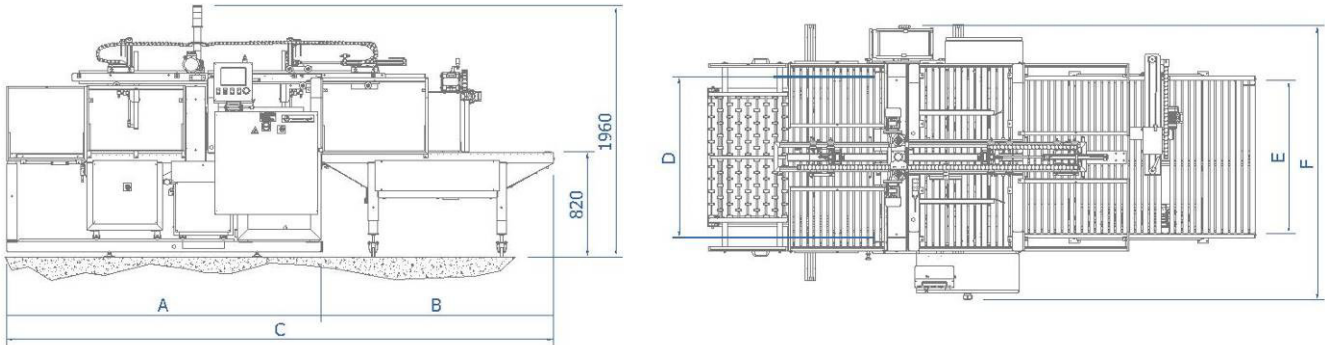

SIZE	A	B	C	D	E	F
1050	2450	1810	4260	1000	1200	1935
1250	2450	1810	4260	1200	1200	2135
1450	2450	2230	4680	1400	1200	2335
1650	2450	2230	4680	1600	1200	2535
1850	2970	2700	5670	1800	2000	2735

The table shows the standard widths between the shoulders and the widths of the machine.